

[Reset](#)
[Download 3D Model](#)

Code Number	COM	* L ₁ mm/inch	* L ₂ mm/inch	* L ₃ max mm/inch
151B3036	160	96.0 [3.78]	119.0 [4.69]	max. 148.0 [5.83]
151B3037	200	101.0 [3.98]	124.0 [4.88]	max. 153.0 [6.02]
151B3038	250	107.3 [4.22]	130.3 [5.13]	max. 159.3 [6.27]
151B3039	315	116.5 [4.59]	139.5 [5.49]	max. 168.5 [6.63]
151B3040	400	127.0 [5.00]	150.0 [5.91]	max. 178.6 [7.03]
151B3041	500	141.0 [5.55]	164.0 [6.46]	max. 193.0 [7.60]

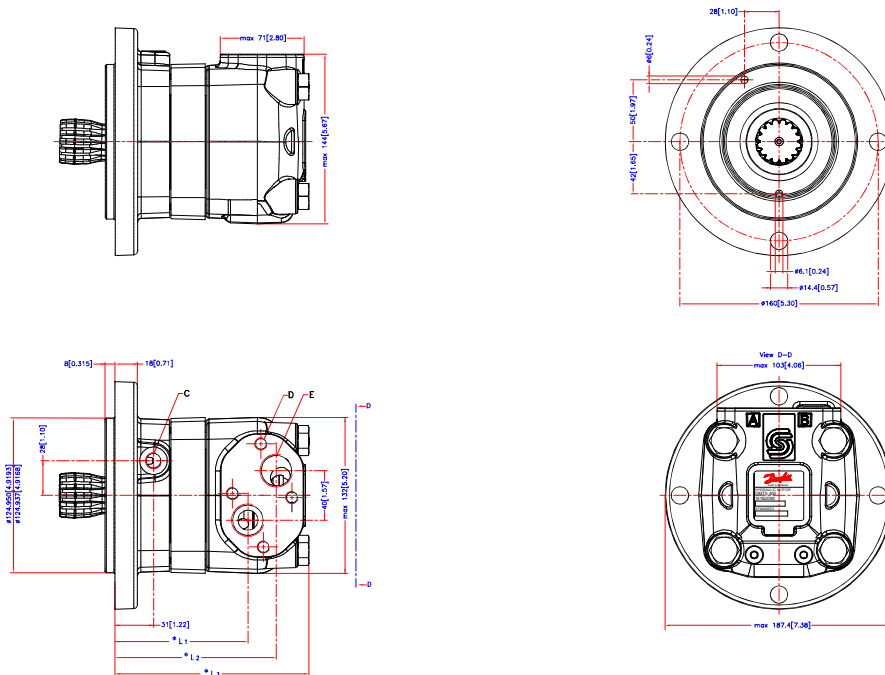

C: drain connection
G 1/4: 12 [0.47] deep
D: M10: 10 [0.39] deep
E: G 3/4: 17 [0.67] deep

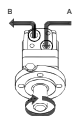

Tolerance for basic dimensions = ±1 mm (0.04 inch)

Revised	Reason	Date	Drawn	Project
1			2014.01.02	
2			2014.01.02	
3			2014.01.02	
4			2014.01.02	
5			2014.01.02	
6			2014.01.02	
7			2014.01.02	
8			2014.01.02	
9			2014.01.02	
10			2014.01.02	

Danfoss

OMTS

No. 8_151D0847